



# INSTALLATION INSTRUCTIONS

APPLICATION: 1999 - UP FORD RANGER 4 - DOOR  
1999 - UP MAZDA TRUCK 4 - DOOR

## AUTOMOTIVE PRODUCTS, INC.

STEP BAR  
ASSEMBLIES

23-1550  
23-1555

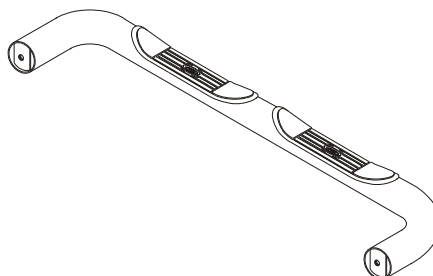

QTY	PARTS KIT CONTENTS DESCRIPTION	TOOLS REQUIRED
1	STEP BAR - DRIVER SIDE	3/4" SOCKET
1	STEP BAR - PASSENGER SIDE	9/16" SOCKET
1	FRONT BRACKET - DRIVER SIDE	9/16" WRENCH
1	FRONT BRACKET - PASSENGER SIDE	TORQUE WRENCH
1	REAR BRACKET - DRIVER SIDE	RATCHET
1	REAR BRACKET - PASSENGER SIDE	
1	NUT PLATE ASSY - DRIVER SIDE	
1	NUT PLATE ASSY - P ASSENGER SIDE	
1	SUPPORT STRAP - DRIVER SIDE	
1	SUPPORT STRAP - PASSENGER SIDE	
1	BACKING PLATE ASSY - DRIVER SIDE	
1	BACKING PLATE ASSY - P ASSENGER SIDE	
4	1/2 -13 X 2.50" LG. HEX HEAD BOLT	
4	1/2" FLAT WASHER, ZINC PLATED	
4	1/2" LOCK WASHER, ZINC PLATED	
12	3/8 -16 X 1.25" LG. HEX HEAD BOLT	
20	3/8" FLAT WASHER, ZINC PLATED	
12	3/8" LOCK WASHER, ZINC PLATED	
8	3/8 -16 HEX NUT	

- STEP 1. Remove the contents from the box and check for any damage. Verify all parts against parts list.
- STEP 2. Read and understand instructions completely before beginning installation.
- STEP 3. Install Front Brackets using hardware supplied and by following Figures 1 through 3.
- STEP 4. Mount Backing Plate to vehicle as shown in Figure 4.
- STEP 5. Attach Rear Bracket to vehicle and Backing Plate as shown in Figure 5.
- STEP 6. Attach Step Bars to Mounting Brackets.
- STEP 7. Tighten and torque 3/8" Fasteners to 30 FT. LBS. And 1/2" Fasteners to 65 FT. LBS.

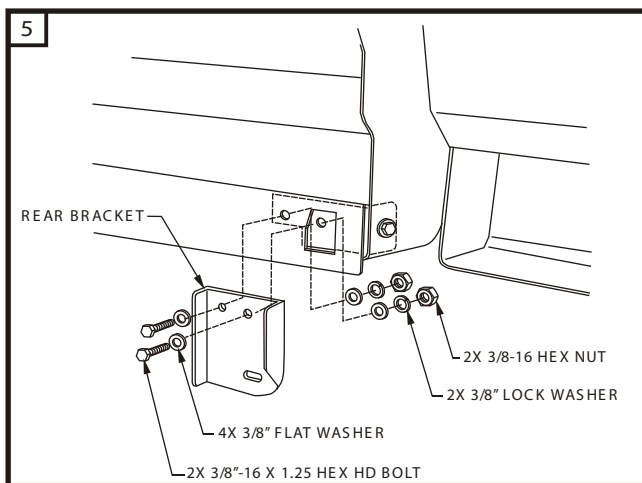
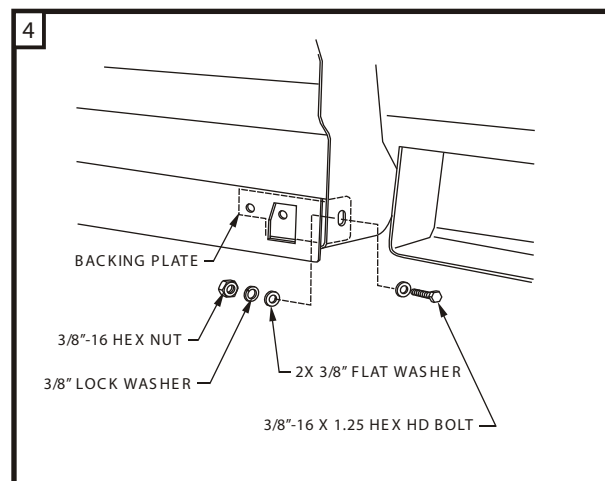
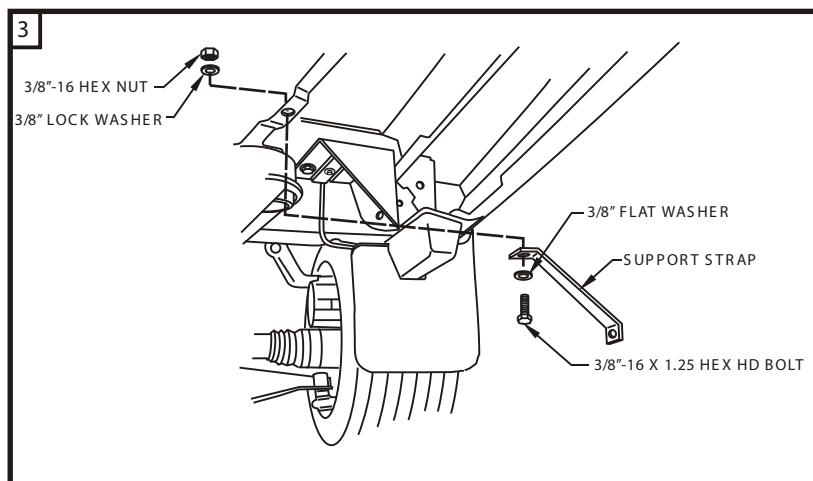
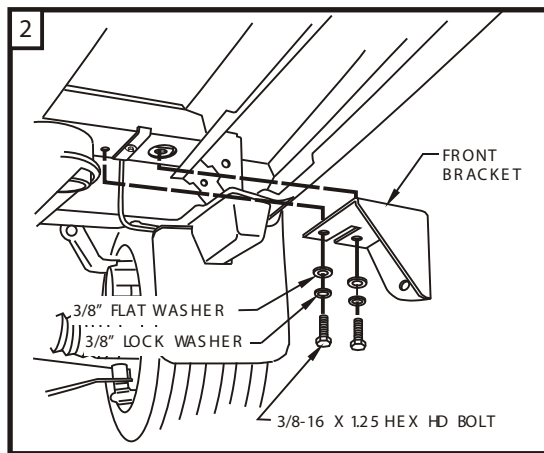
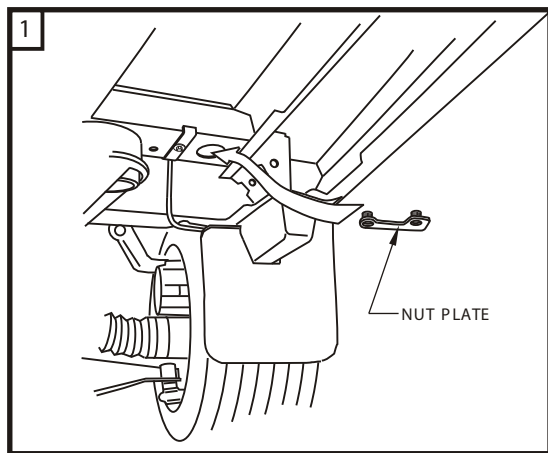

NOTE: INSTRUCTIONS SHOWN ARE FOR PASSENGER SIDE INSTALLATION. DRIVER SIDE INSTALLATION IS OPPOSITE.

Finish protection - Westin products have a high quality finish that must be cared for like any other exposed finish on the vehicle. Protect the finish with a non-abrasive automotive wax (pure carnauba, for example) on a regular basis. The use of cleaner wax or any compound which contains an abrasive is detrimental, as the compound scratches the finish and opens it to corrosion.



Westin Automotive Products, Inc.  
5200 N. Irwindale Ave. Suite 220  
Irwindale, Ca. 91706

Thank You for choosing Westin products  
For additional installation assistance please call  
Customer Service (800) 345-8476