

Installation Guide 2004-C GMC CANYON/CHEVY COLORADO Product No. 2159

QTY.	DESCRIPTION	QTY.	DESCRIPTION
1	GlaStep #2159-D (Drivers Side)	8	Angled Straps #AS01
1	GlaStep #2159-P (Passenger Side)	8	Step Supports #3124F
2	Step Pads	32	5/16" x 3/4" Washer Head Bolts
2	Foam Tape Strips	32	5/16" Washer Head Nuts
8	Flat Plates #FL94	16	#14 x 3/4" Self Drilling Screws (SHORT)
8	M8 Blind Hole Nut	6	#12 x 1-1/4" Self Drilling Screws With Rubber Washers (LONG)
8	M8 x 3/4" Bolt		

TOOLS REQUIRED: 5/16" DRILL • 1/2" HEX SOCKET • 1/2" WRENCH • 5/16" NUT DRIVER • 3/8" NUT DRIVER

SOME DRILLING INTO THE BODY IS REQUIRED

1. Prior to painting, fit your GlaSteps to the body. A good fit is accomplished when mating surfaces fit with minimum light gaps. Note: Vehicle bodies have variations and a perfect fit may not be possible.
2. Painting your GlaSteps. To insure a proper paint finish, use a top quality auto paint system and follow the manufacturers instructions. Your GlaSteps should be sanded and primed before painting.

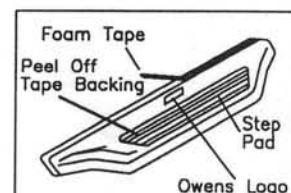
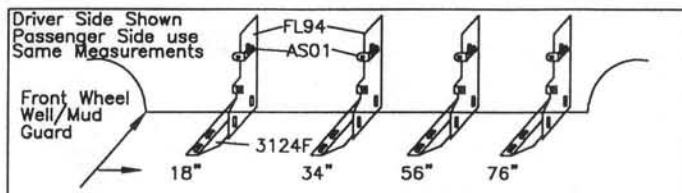

3. Measure from the wheel well, back to the dimensions shown above. Mark these bracket location centers. Note: Steel plates have been inserted under fiberglass to mount brackets. Double check your marks to be sure they line up with the steel plates before drilling. Also there are many holes, USE THE RIGHT ONES!

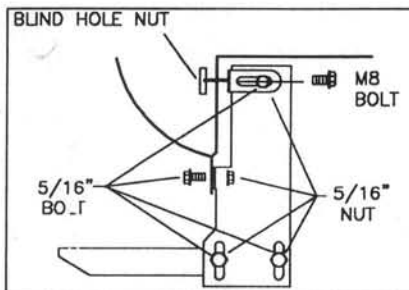

4. Insert a blindnut into the factory holes at the locations shown above. Attach a AS01 bent tab at each rivnut location, now attach a FL94 to the bent tabs. Drill a 5/16" hole through the pinch weld at each flat bracket location, lined up with the hole in the bracket.

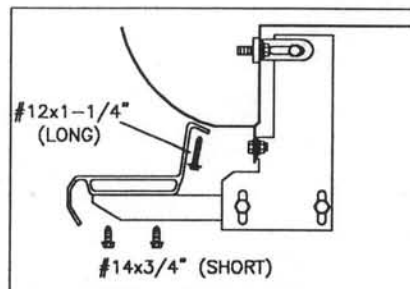

7. Make sure your GlaSteps are level, tighten all bolts to 18 foot pounds. Do not overtighten the sheet metal screws, the sheet metal is thin. Do not overtighten.

6. Position step on brackets and tight to truck body. Screw step to truck with #12 x 1-1/4" self-drilling screws with rubber washers (LONG), three per side. Secure step support bracket to bottom of GlaStep using two #14 x 3/4" self-drilling screws (SHORT) per bracket. Repeat for all brackets. DO NOT USE LONG SELF TAPPERS UNDER THE BOARD!

IN260 02/10/04

OWENS PRODUCTS*1000 PROGRESS STREET*STURGIS, MI 49091*616-651-2300*TOLL-FREE: 800-726-9367*FAX:616-651 9326*WEB:www.owens-pro.com

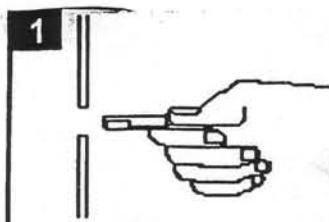

Hold tab of Inpull Nut as shown above and insert into pre-drilled hole.

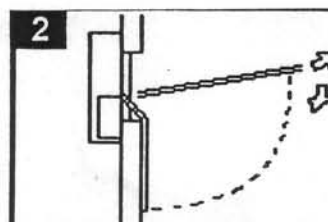

Pull tab toward you (Slightly upward). Then bend down the tab.

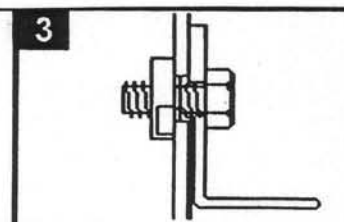

Position an article to be fastened and fasten it with a bolt.