



**Instruction Sheet
C4 CORVETTE STREET ADJ.
UPPER CONTROL ARMS**

This part should only be installed by personnel who have the necessary skill, training and tools to do the job correctly and safely. Incorrect installation can result in personal injury, vehicle damage and / or loss of vehicle control.

#94368 (RIGHT) / #94369 (LEFT)
1984 - 87 C4 CORVETTE STREET
STYLE UPPER CONTROL ARM -
Adjusts from 7-1/2" TO 9-1/2", Steel Cross
Shaft Street Style W/ 6-1/2" Bolt Hole
Spacing, OE Clevite Bushings W/ Custom
Pivots, 2 - 4" Aluminum Adj. Sleeves, 1 - Mid
Size Corvette Bolt In Ball Joint Plate

#94370 (RIGHT) / #94371 (LEFT)
1988 - 96 C4 CORVETTE STREET
STYLE UPPER CONTROL ARM -
Adjusts from 7-1/2" TO 9-1/2", Steel Cross
Shaft Street Style W/ 5-1/2" Bolt Hole
Spacing, OE Clevite Bushings W/ Custom
Pivots, 2 - 4" Aluminum Adj. Sleeves, 1 - Mid
Size Corvette Bolt In Ball Joint Plate

Figure 1

*Please Note:
Drawing is for
torque and
adjustment
info only,
enclosed
arm may
differ from
illustration.*

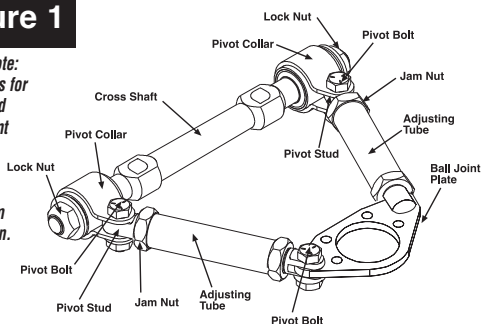

This arm accepts the standard **SPC Performance Ball Joint - Part No 94007** or Moog K6346, or equivalent, bolt in style ball joint.

Adjusting the Arm: Tighten the lock nuts on the ends of the cross shaft so the pivot bushings have minimal play, but so the pivot bushings are still free to turn on the shaft. Slightly loosen the three pivot bolts (see diagram). Loosen the jam nuts on both ends of each adjusting tube (the ends closest to the cross shaft are left hand thread). Turn the adjusting tubes to lengthen or shorten the arm. After you have

adjusted the arm to the desired length, tighten down the jam nuts against the adjusting tubes, and then tighten each of the three pivot bolts to 60 lb-ft of torque. **There should never be more than 1" of thread showing past the tightened down jam nuts on either end of both adjusting tubes.** With the vehicle at its final ride height, tighten down the lock nuts on the ends of the cross shaft to a minimum of 72 lb-ft of torque. **Note: The vehicle must be at it's final ride height when tightening the cross shaft lock nuts to prevent the rubber pivot bushings from being damaged.**

There is no warranty stated or implied due to the inability to monitor the part's modification, installation, and use, except that Specialty Products Company warrants its products to be free from defects in material and workmanship for 90 days after purchase under normal use. In that case, parts returned must be determined by Specialty Products to be defective and Specialty Products's obligations under that warranty are solely limited to repairing or replacing, at its option, any part proven defective.

Final determination of the suitability of the parts for use contemplated by the buyer is the sole responsibility of the buyer. Specialty Products Company shall not be liable for any special, direct, indirect, incidental, or consequential damages that might be claimed as a result of the failure of any part, including claims for delay, loss of profits or labor. Specialty Products Company shall not be liable for any damage or injury to persons or property resulting from improper installation or misuse of any part subject to this warranty. There are no other warranties expressed or implied extending beyond those set forth above.



Specialty Products Company®

P.O. Box 923 • Longmont, CO 80502 • (303) 772-2103 • Fax: (303) 772-1918
www.specprod.com • www.spcperformance.com • Email: info@specprod.com
Toll Free Technical Hot Line: 1-800-525-6505