

FORD FOCUS FRONT CASTER/CAMBER KIT

All products available from Specialty Products Company are intended for use by professional installers only.

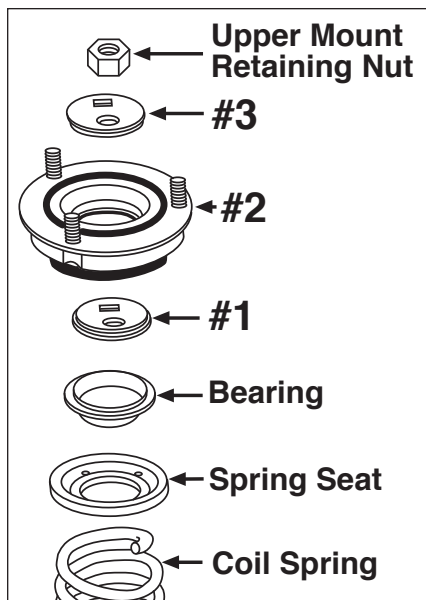

1. Always check for loose or worn parts, tire pressure and tire wear. Determine camber change needed.
2. Raise vehicle by body pinch welds. Remove tire and wheel assembly.
3. Remove strut assembly from vehicle by following manufacturer's recommended procedure.
4. Place strut assembly in strut vise, compress spring, and remove upper mounting plate. Leave spring seat on spring.
5. Remove bearing from the OE strut mount and place on the 81320 strut mount.
6. Install one of the cam plates (#1) onto the strut shaft with the ledge facing up. Install the 81320 mount on the strut shaft and place the other cam plate over the strut shaft with the ledge facing down. Thread the 12mm nut on the strut shaft. Ensure that both cam plates are engaged in the 81320 mount and tighten the strut shaft nut.

7. Remove strut from vise and reinstall into vehicle using manufacturer's recommended procedure. Torque the 3 strut mount to fender nuts to 15 - 18 lb-ft. (180-215 lb-in.).

CAUTION: DO NOT OVERTIGHTEN.

8. Reinstall wheel, alignment equipment, recompensate and lower the vehicle down onto the turnplates.
9. To adjust strut for camber and caster change, loosen the strut shaft nut 1/2 turn. Rotate the cam plate by installing a 3/8" ratchet and extension in the square hole.
10. Caster and camber correction will be determined by the location of the strut shaft. (e.g. if the strut shaft is towards the engine you will get negative camber change, if the strut shaft is towards the front of the car you will get negative caster change.)
11. When adjustments are complete, torque to 45 lb-ft.

Always check for proper clearance between suspension components and other components of the vehicle.

12. Recheck alignment readings and road test vehicle.

**Specialty Products Company®**

P.O. Box 923 • Longmont, CO 80502 • (303) 772-2103 • Fax: (303) 772-1918

www.specprod.com • www.spcperformance.com • Email: info@specprod.com

Toll Free Technical Hot Line: 1-800-525-6505

©2004 Specialty Products Company • Printed in U.S.A. • Form No. 98320 • Rev. 6/04