

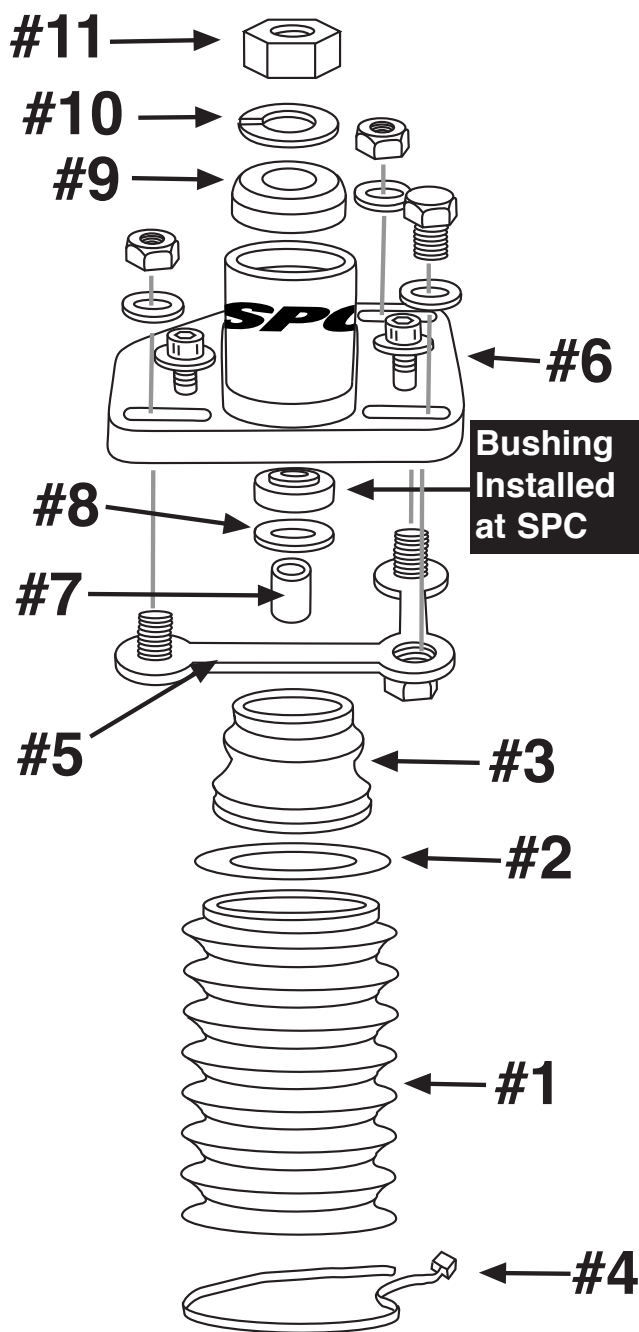

This part should only be installed by personnel who have the necessary skill, training and tools to do the job correctly and safely. Incorrect installation can result in personal injury, vehicle damage and / or loss of vehicle control.



Driver's Side Shown

1. Raise the front of the vehicle by the body and support securely with jack stands. Remove front wheels.
2. Place a jack under the lower control arm and lift until the weight is off of the upper strut mount. **DO NOT lift vehicle off of jack stands.**
3. Remove the strut nut off the top of the strut. Lower floor jack until strut shaft starts to lower out of strut mount.
4. Remove the two large bolts holding the strut to the spindle then remove strut from vehicle.

Use caution not to stretch brake lines or ABS wires.

5. Remove the stock plastic boot and remove the strut bump stop.
6. Slide **new boot #1** over strut with smaller opening at the top. Place **plastic ring #2** on lower slot of new **bump stop #3** and install bump stop over strut shaft making sure it is pulled over the large part of the shaft. Fit slot in boot over plastic ring. Fasten lower part of boot to strut housing using **plastic tie strap #4**.
7. Remove the bolts holding the stock strut mount to the body and remove mount. It may be necessary to drill out two small rivets to remove mount.
8. Remove **L-bracket #5** from new **camber/caster plate #6**. Reach into the fender well and insert L-bracket studs through holes in strut tower and the chrome plate. Attach the plate with the fasteners supplied but do not tighten.
9. Place the **spacer sleeve #7** and the **washers #8** (up to three) on the strut shaft.

The washers are used to position the strut shaft in the mount. Depending on what type of strut you are using the amount of spacers will vary. One washer will give more strut travel for lowered vehicles but the strut shaft may hit the hood when the hood is closed. DO NOT close hood before checking clearance. Up to three washers can be installed on the strut shaft for maximum clearance.

10. Install the strut into the vehicle by first putting the shaft up through the mount. Place **top polyurethane bushing #9** with the beveled side up, **flat washer #10** and then **stock strut nut #11**. Tighten nut until the polyurethane bushing just starts to bulge at sides.

Make sure both polyurethane bushings, spacer, and spacer washers are installed correctly.

11. Reattach the strut to the spindle using two large bolts and tighten to manufacturers specifications. Remove floor jack.
12. Center sliding upper plate and lightly tighten nuts. Reinstall wheel and alignment equipment and recompensate.
13. Adjust camber by loosening the three larger fasteners and sliding the plate side to side. Adjust caster by loosening the three larger fasteners and the two smaller bolts and sliding the strut forward or rearward. After adjustments are complete, tighten three larger nuts to 40 lb-ft and the two smaller bolts to 20 lb-ft

Recheck alignment readings, set toe, and road test vehicle.



Specialty Products Company®

P.O. Box 923 • Longmont, CO 80502 • (303) 772-2103 • Fax: (303) 772-1918 • www.specprod.com • www.spcperformance.com • Email: info@specprod.com

Toll Free Technical Hot Line: 1-800-525-6505

©2004 Specialty Products Company • Printed in U.S.A. • Form No. 98061 • Rev. 9/04