

Figure 1

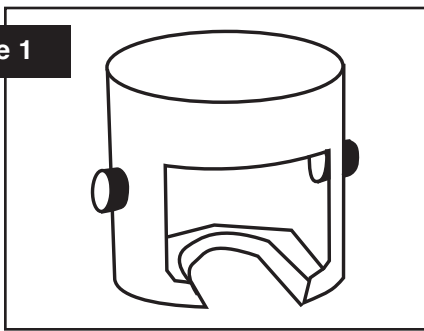

Figure 2

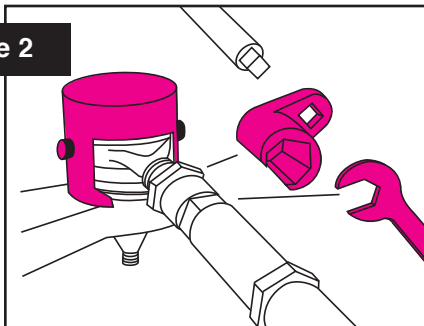

Figure 3

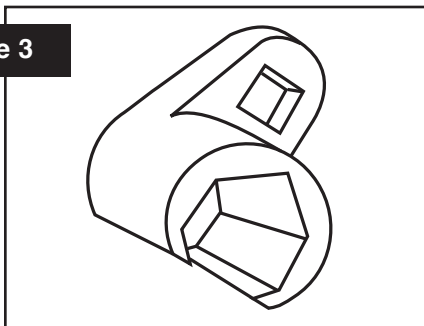
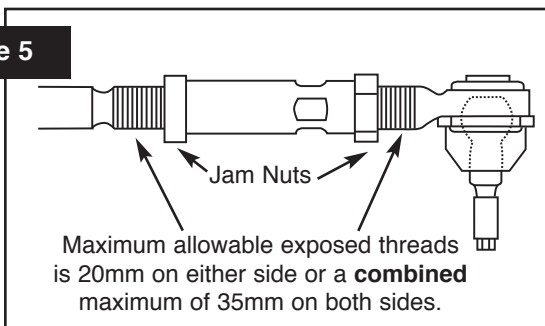

Figure 4



Figure 5



## 55600 LH Toe Tool Usage Instructions

Note: Start vehicle and center the steering wheel. Lock the steering wheel in place with a steering wheel holder. Shut off the vehicle. Begin the following alignment procedure with the side of the vehicle that requires the most change.

**CAUTION:** The outer tie rod housings on these vehicles have a tendency to rotate off the center of the ball stud. This can cause abnormal tire wear and alter the toe settings. Therefore, it's very important that the outer tie rod housing be secured during this procedure.

### Instructions

1. Install the tie rod end stabilizer socket (**Figure 1**) over the tie rod housing and secure the housing by tightening the cap screws.
2. Install the hex socket (**Figure 3**) over the tie rod jam nuts with the deep portion of the socket facing towards the engine (inboard).
3. Using a 1/2 inch drive and extension, slide the hex socket either inward or outward to contact the jam nuts. Turn both nuts counter-clockwise to loosen.
4. Using the wrench, adjust toe to specifications (**Figure 4**).
5. Repeat steps 1 through 4 for the other side of the vehicle.
6. With the tie rod stabilizer socket still tightly installed over the tie rod housing, use the wrench to hold the tie rod sleeve and tighten, in sequence, the outboard jam nut and then the inboard jam nut. Torque both nuts per manufacturer's specifications.
7. Upon removal of the tie rod end stabilizer socket, check to ensure that the tie rod housing is perpendicular to the ball stud.
8. Repeat steps 6 and 7 on the other side of the vehicle.

**CAUTION:** The maximum amount of exposed threads allowed on the inner and outer tie rod ends can not exceed 20mm on either side (or 35mm combined on both sides). See Figure 5.



**Specialty Products Company** • 4045 Specialty Place • Longmont, CO 80504 U.S.A.

Toll Free: 1-800-525-6505 • 303-772-2103 • Fax 303-772-1918

Email: [info@specprod.com](mailto:info@specprod.com) • Internet: [www.specprod.com](http://www.specprod.com)

Printed in U.S.A.  
Form No. 55600-6 Rev. 8/97