



P.O. Box 1719  
Corona, CA 92878  
Support: 877-512-8111  
www.aFeilters.com

# Intake Kit Installation Instructions: '04 -'06 Ford F-150 V8-5.4L Stage 2 Si

<b>Kit Part #</b> 54-80512C / 54-80512M			<b>Tools Required:</b>		<b>Part List:</b>		5- M6 wavy washers		1- Adapter, injection molded
51-80512C Pro Dry S™			5/16" nut driver		1- Air filter P/N ( 24-90032 or Pro Dry S™ 21-90032 )		3- Clamps #064		1- Cover, housing
51-80512M Pro Dry S™			10mm socket		1- Air filter housing		1- Clamps #056		1- Nut, M6
<b>Make:</b> Ford			Flathead screwdriver		1- Intake tube rotomolded		2- Nylon spacers 1/8"		
<b>Model</b> F-150			Ratchet and extension		1- Intake tube support bracket		1- Coupler, straight(4" x 3")		
<b>Year</b> '04 -'06			T-20 Torx bit		1- MAF sensor gasket		1- Coupler, elbow (3.5" x 4.0")		
<b>Engine</b> V8 - 5.4L			5/32" allen key		11- M6 x 1 x 10 button head screws		17"- Hose, vent 5/16"		
Mark LT (Lincoln) 2006					2- M6 x 1 x 12 hex head screws		15"- Trim seal bulb		
					9- M6 flat washers		1- M6 x 1 x 25 hex head screws		
					2- 8-32 x 5/8" screws		1- M6 x 1 x 30 hex head screws		

Step 1



Complete kit with parts.

Step 2



Complete stock intake.

Step 3

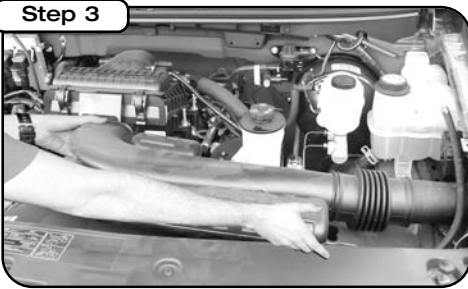

Disconnect negative post from battery terminal. Remove intake air duct by grabbing firmly from both sides and pulling straight back and out.

Step 4

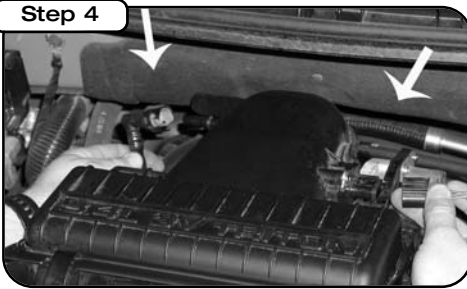

Disconnect the MAF sensor and breather tube on the sides of the air box. Remove the (4) 10mm screws holding the air box to the intake manifold and remove intake box.

Step 5

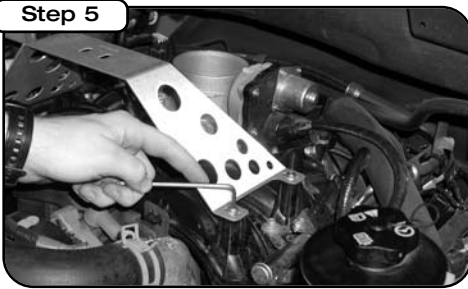

Install the intake tube support bracket to the intake manifold and fasten with the supplied M6 x 1 x 10 button head screws and washers.

Step 6



Push clip holding factory wire harness and push to the side, this allows more room for housing. Remove bolt holding in radiator support and set aside for later use. Install trim seal to new housing fender scoop.

Step 7



Install housing into vehicle. With hardware provided, install M6 x 1 x 30 screw and washer into radiator support. Install to bottom of housing, M6 x 1 x 25 screw with washers and M6 nut. With screw from step 6 install into hole with threaded insert, also in bottom of housing.

Step 8

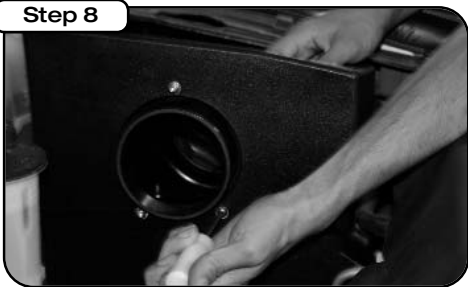

With button head screws and wavy washers install filter injection molded adapter. Tighten using 5/32" allen key.

Step 9

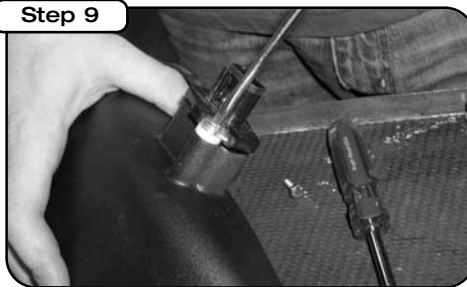

Transfer the MAF sensor from the factory air box to the new intake tube. Make sure you use the provided spacers and gasket between sensor and tube.

Step 10

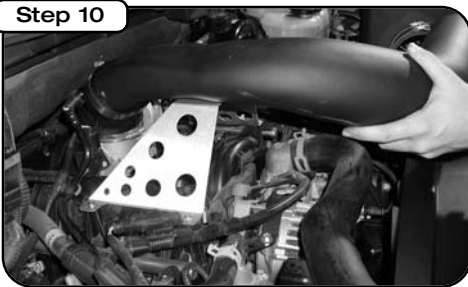

Place urethane coupler on the throttle body (see diagram below for correct coupler position) and the housing. Position intake duct into engine bay and tighten down the clamps.

Step 11

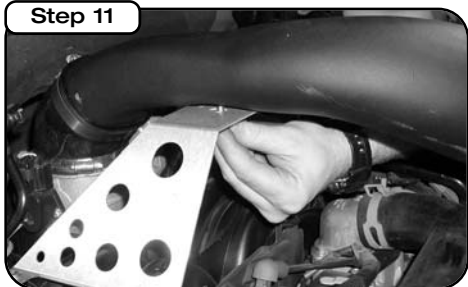

Line up the mounting holes on the intake duct and tighten assembly with the provided screws and washers.

Step 12

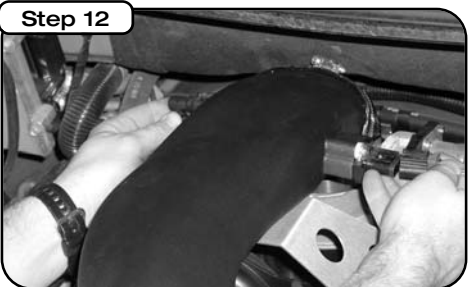

Re-connect the MAF sensor and use provided 5/16" breather hose to connect the intake duct to the crankcase breather on the engine valve cover.

Step 13

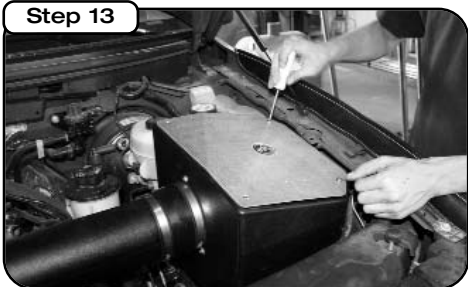

Install the pre-oiled filter in the housing and tighten down clamp. With button head screws, install housing cover and tighten using 5/32" allen key.

Step 14

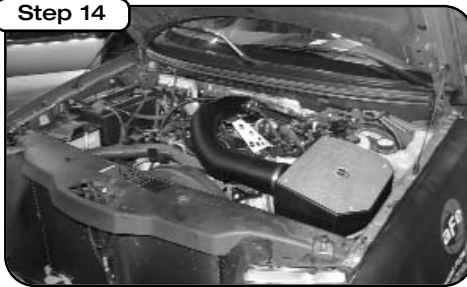

**Your installation is now complete.** Check after a few hours of operation all hoses and clamps are tight and that all electrical components are secure. Thank you for choosing aFe!



Position coupler and clamps over throttle body (3.5" x 4.0") (clamps removed for clarification). The smaller (3.5") end of the coupler goes over the throttle body. The (4") end of the coupler goes around the intake tube.