



Part Number RD1670

1998-02 Honda Accord 4 Cyl.

Please read bold print on the lower right hand side for test group or engine family which are not CARB exempt.

- 1 Injen cold air Intake System
- 1 2 3/4" Injen filter (#1013)
- 2 2 3/4" straight hose (#3043)
- 1 10" 10mm Vacuum Hose (#3077)
- 4 Medium clamps (.048) (#4004)
- 2 rubber vibra-mount (#6020)
- 2 m6 flange nut (#6002)
- 2 fender washer (#6010)
- 1 License Plate Frame (#9010)
- 1 Instruction

Note: This intake system was designed and tested with this filter element and parts. The use of any other filter or part void the CARB exemption number.

Parts and accessories are sold on-line at "injenonline.com"

Congratulations! You have just purchased the best engineered, dyno-proven cold air intake system available.

Please check the contents of this box immediately.

Report any defective or missing parts to the Authorized Injen Technology dealer you purchased this product from.

Before installing any parts of this system, please read the instructions thoroughly. If you have any questions regarding installation please contact the dealer you purchased this product from.

Installation DOES require some mechanical skills. A qualified mechanic is always recommended.

***Do not attempt to install the intake system while the engine is hot.** The installation may require removal of radiator fluid line that may be hot.

Injen Technology offers a limited lifetime warranty to the original purchaser against defects in materials and workmanship. Warranty claims must be handled through the dealer from which the item was purchased.

Injen Technology 285 Pioneer Place Pomona, CA 91768 USA

Please read carefully before installing this intake:

The following SULEV vehicles with the engine test group numbers do not satisfy or meet the California air resources board testing procedures. These test group numbers can be found on the tune-up or underhood information label located on the drivers side.

The use of this intake for the following vehicles is for off road only.

2001 Accord 4 Ex cylinder Engine test group number 1HNXV02.3BF9

2002 Accord 4 Ex cylinder Engine test group number 1HNVX02.3FK6

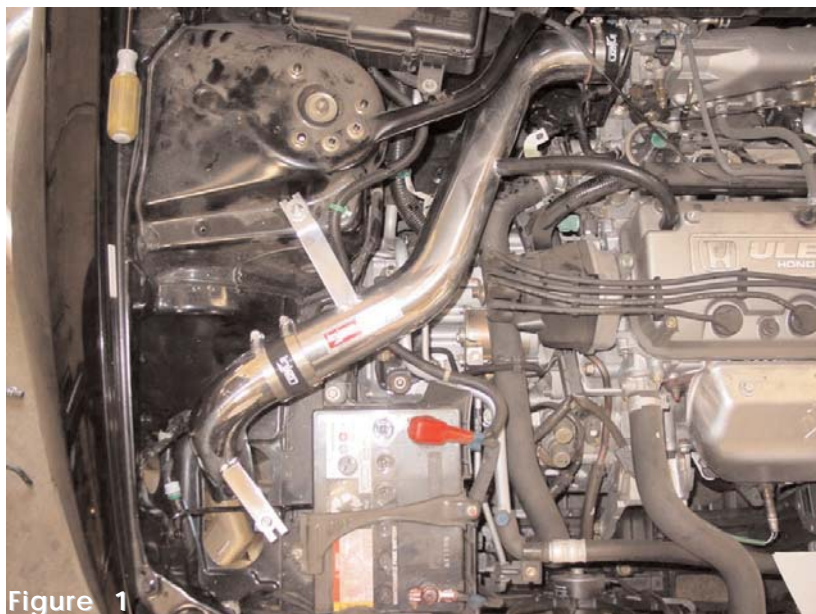

Figure 1

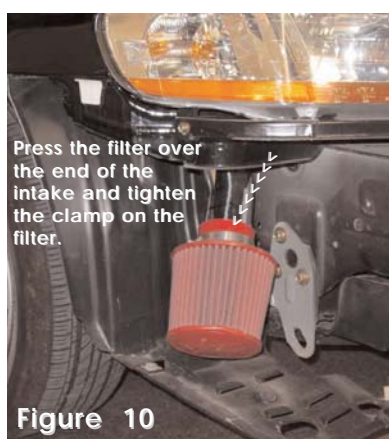
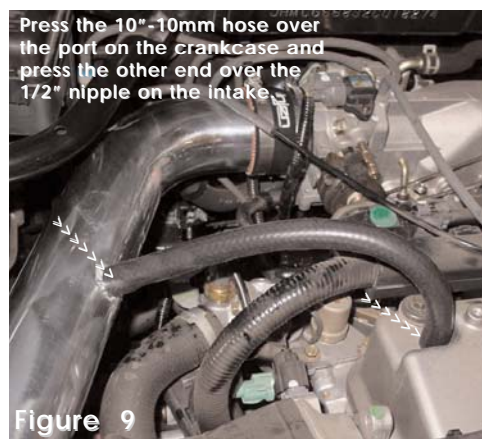
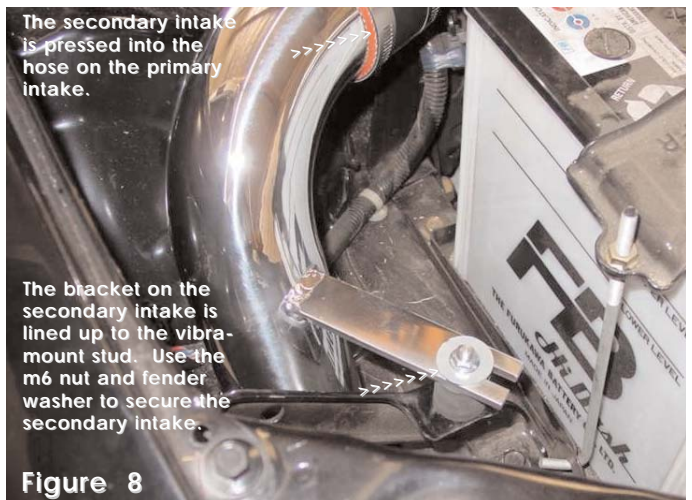
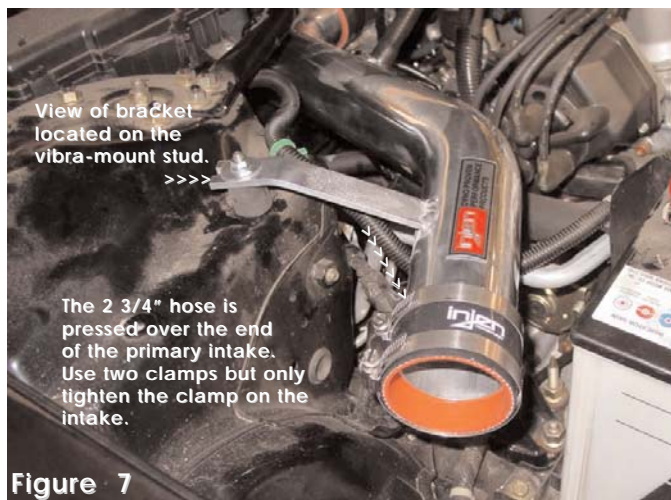
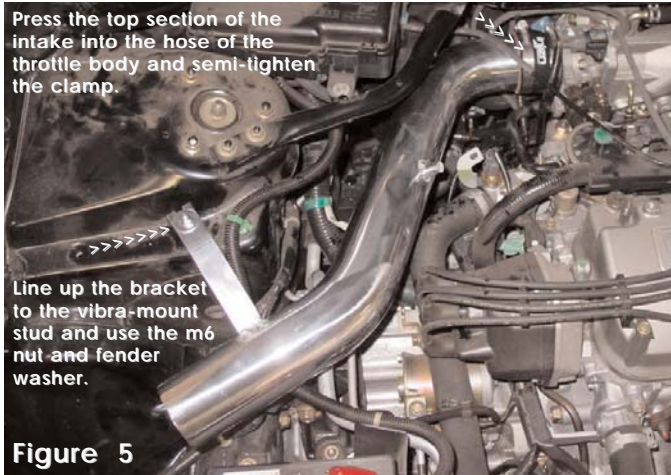
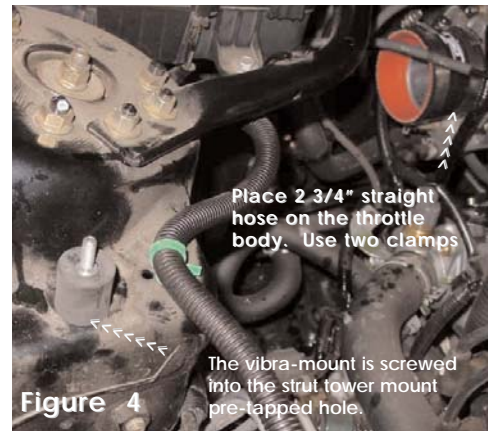
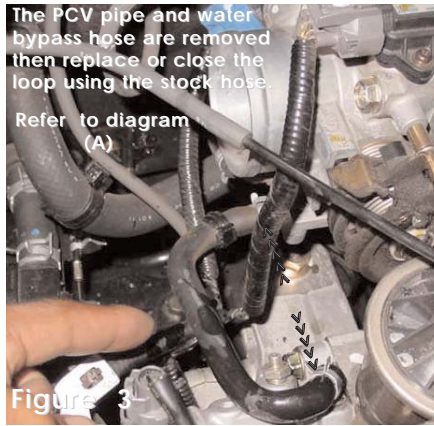
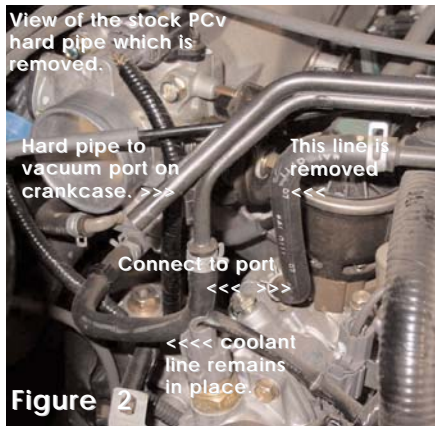
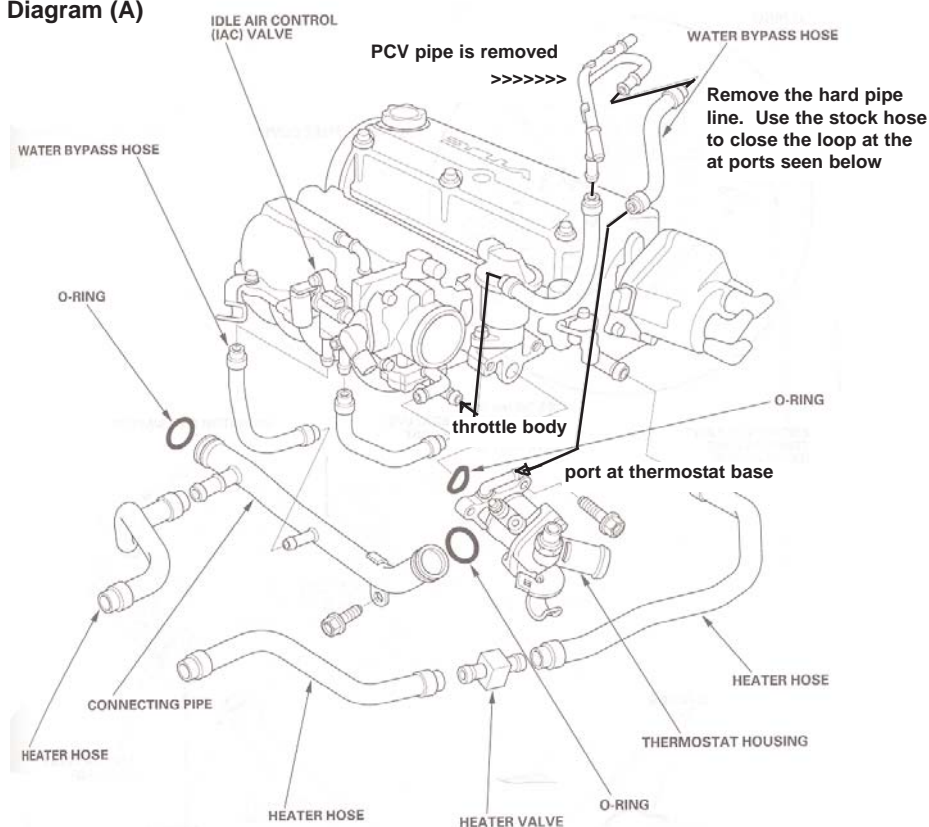

Diagram (A)



Note: Disconnect the negative battery terminal prior to starting this installation.

- 1 Remove the air intake box, vacuum lines and air intake duct leading to the throttle body. Remove the front bumper and air box resonator located on the on the passenger side of the bumper.
Make sure the engine has had enough time to cool down prior to removing any lines
- 2 Remove the PCV pipe and water bypass hose. See diagram (A) Reuse the stock hose to close the loop or reconnect the coolant line. Use the stock clamps to secure the hose. (See figs 2 & 3)
- 3 Place the 2 3/4" straight hose on the throttle body and use two clamps. Tighten the clamp on the throttle body at this point. (See figure 4)
- 4 Screw the first vibra-mount into the pre-tapped hole in the strut tower mount. (See fig. 4)
- 5 Insert the top of the intake into the 2 3/4" straight hose on the throttle body and line up the bracket on the primary intake to the vibra-mount stud, use the m6 nut and fender washer to secure the intake in place. (See fig. 5) See figure six for a better shot.
- 6 Screw the second vibra-mount into the fender support brace located near the battery. (See fig. 6)
- 7 Press the second 2 3/4" straight hose over the end of the primary intake and use two clamps. Tighten the clamp on the intake side at this point. (See fig. 7)
- 8 Take the secondary intake and press the top end into the hose on the primary intake. Line up the bracket on the intake to the vibra-mount stud and use the m6 nut and fender washer. (See fig. 8)
- 9 Take the 10"-10mm braided breather hose and slip one end over the crankcase port and the other end over the 1/2" nipple on the intake. (See figure 9)
- 10 Place the Injen 2.75" filter over the end of the secondary intake located in the bumper area be sure to tighten the clamp on the filter. (See fig. 10)
- 11 Align the entire cold air intake for best fit. Make sure that there is no rubbing anywhere along the length of the intake. Once proper clearance has been made continue to tighten all nuts, bolts and clamps. (See figure 1)
- 12 Replace the front bumper back to it's stock location and reconnect the battery terminals.
- 13 Remove all tools and loose articles from the engine compartment prior to starting your engine.
- 14 Congratulations! You have just completed the installation.